



a truly memorable holiday experience...

# Freme Holidays



**FREME Travel :** Kuala Belait 3335025/035 || Bandar 2234277-79 || Seria 3228171-74 || Tutong 4260519-21

**JJ Tour :** Kuala Belait 3333181/267 || Bandar 2453110/112/116/117

Website : [www.freme.com](http://www.freme.com)

Email : [holidays@freme.com](mailto:holidays@freme.com)

Prices are Subject to Change without Prior Notice

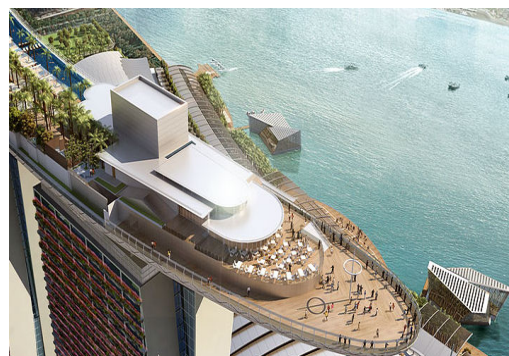

## 3Days 2Nights Marina Bay Sands Singapore

**Code:** FIT- P310P

**Destination:** Singapore

**Validity:**

Till 30<sup>th</sup> September 2010

**Minimum 2 person to travel.**

**Includes:**

- i) Return Economy Airfare Brunei-Singapore-Brunei
- ii) 02 Night hotel accommodation at Marina Bay Sands in the Club Room.

**Excludes:**

- i) B\$117 per adult/child Airport Taxes & Fuel Surcharges
- ii) Meals
- iii) Visa Fees

**Note:**

- i) No refund for unused services.
- ii) Ensure valid visa to Singapore
- iii) Personal Travel Insurance **from B\$25.**

**TERMS & CONDITIONS APPLY**

### IMPORTANT NOTICE

Rates and Tour information are correct at the time of publishing/printing and are subject to changes without prior notice. Please confirm all details at the time of booking.

Kindly note that it is the passenger's sole responsibility to Reconfirm & Recheck flight departure times at least three (3) days before departure to ensure flight timings are correct.

270710/A89/GRACE

Day 01	Depart Brunei to Singapore. Upon arrival, shuttle service to hotel Free at leisure. Overnight at Marina Bay Sands Hotel.
Day 02	Free at Leisure. Overnight at Marina Bay Sands Hotel.
Day 03	Free at leisure till your shuttle service to airport. Depart Singapore to Brunei.

Rates in Brunei Dollars per person	TWIN	SINGLE	CHILD NO BED
Marina Bay Club	\$ 747	\$1,269	\$ 445

### Marina Bay Club Room Benefits:

- ★ Complimentary pressing of clothing 1 piece daily.
- ★ Complimentary local calls
- ★ Access to Marina Bay Club Lounge
- ★ Sky Observation Deck for 2 persons per room (additional guest chargeable)
- ★ Complimentary internet access & printing service (Max 10 copies daily)
- ★ F & B offerings at Fuse lounge at Lobby Level
- ★ Daily breakfast for 2 adults only
- ★ Non alcoholic beverages & Espresso & Tea station throughout the day
- ★ Canapés & Wine & Alcoholic drinks during cocktail hour
- ★ Signature dish sampler from Celebrities Chef on weekend nights during cocktail hour.
- ★ Complimentary Airport Shuttle Bus on arrival.
- ★ **Optional:**

Sky Park Observation Deck Ticket cost: \$30 per adult / B\$ 24 per child (02-12years old)

### Additional Notes:

- ★ Child stay with No Bed allowed for below 6 years old.
- ★ Child with bed rates please enquire with our consultants.
- ★ Child breakfast included in price.
- ★ Rates quoted base on Special promotional airfares and subject to terms & conditions.
- ★ Upgrade to K Class during Peak season add B\$135 per adult / B\$70 per child.
- ★ Travel on SQ flights add B\$30 per adult.
- ★ Standard check-in time 1400hrs, check-out time 1200noon
- ★ Late check-out from 1800hrs onwards is chargeable at 50% up to full day room rate.
- ★ Peak : August & September 2010
- ★ We highly recommend purchasing of Travel Insurance before commencing on your holiday.

